

## *Specifications*

- Current rating:50A AC,DC
- Voltage rating:600V AC,DC
- Temperature range:-40°C~+105°C
- Contact resistance:10mΩMax.
- Insulation resistance:1000MΩMin.
- Withstanding voltage:5000V AC/minute
- \*Compliant with RoHS and REACH\*
- \*Meet the HF/Halogen Free,GWT/Glow wire Test (IEC60335-1) request,need to customize\*
- \*Contact CJT for details\*

### A2361WVA-XP-S

10.00mm pitch 180° Wafer

**Reference Informations:**

- \*Material:Pin:Brass/Tin over Nickel  
Insulator:Nylon 46+30%GF,UL94V-0
- \*Color:Black

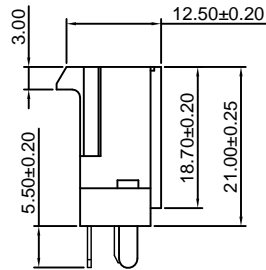
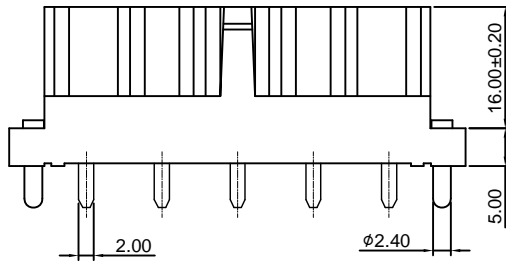
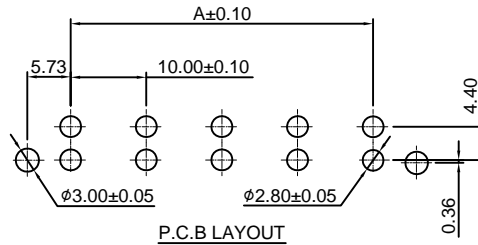
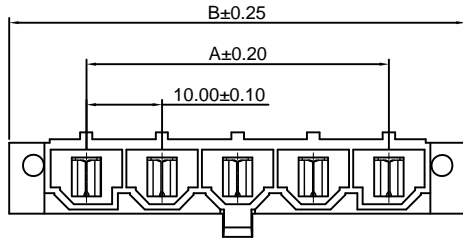
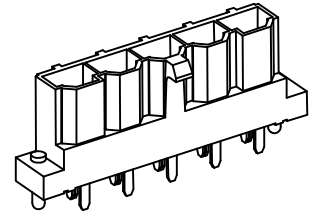

**Ordering Information & Dimensions:**

PART NO.	Dimensions	
	A	B
2P	10.00	30.30
3P	20.00	40.30
4P	30.00	50.30
5P	40.00	60.30
6P	50.00	70.30

Unit: mm

### A2361WRA-XP-S

10.00mm pitch 90° Wafer

**Reference Informations:**

- \*Material:Pin:Brass/Tin over Nickel  
Insulator:Nylon 46+30%GF,UL94V-0
- \*Color:Black

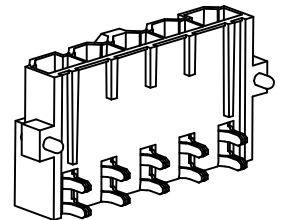
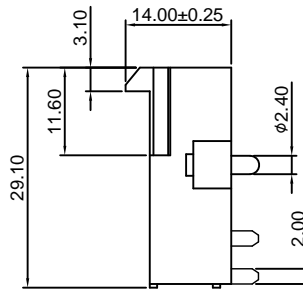
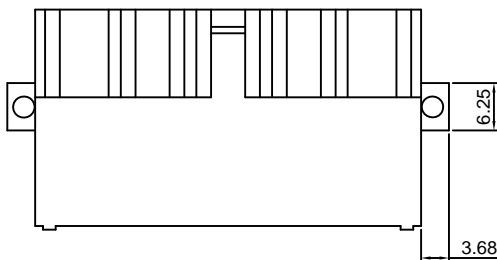
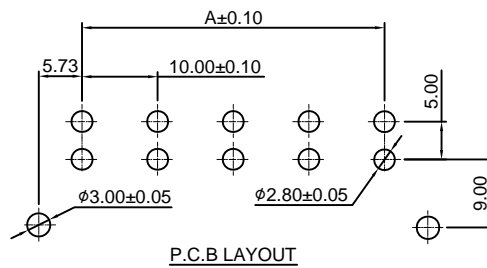
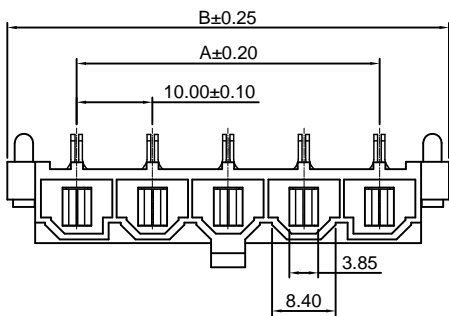

**Ordering Information & Dimensions:**

PART NO.	Dimensions	
	A	B
2P	10.00	30.30
3P	20.00	40.30
4P	30.00	50.30
5P	40.00	60.30
6P	50.00	70.30

Unit: mm