

**SPECIFICATIONS:**

Current Rating: 0.2A AC,DC  
 Voltage Rating: 30V AC,DC  
 Temperature Range: -40°C ~ +105°C  
 Contact Resistance: 30mΩ Max.  
 Insulation Resistance: 100MΩ Min.  
 Withstanding Voltage: 200V AC/minute  
 Terminal Material: Phosphor Bronze/Gold over Nickel  
 Material: LCP , UL94V-0(Black)

**Ordering Information & Dimensions**

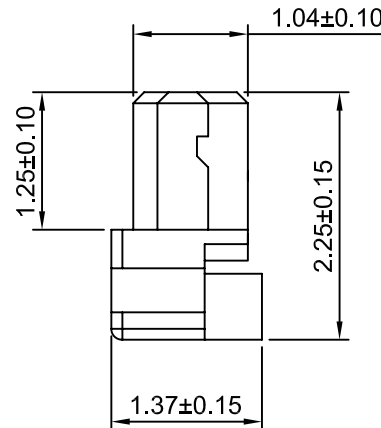
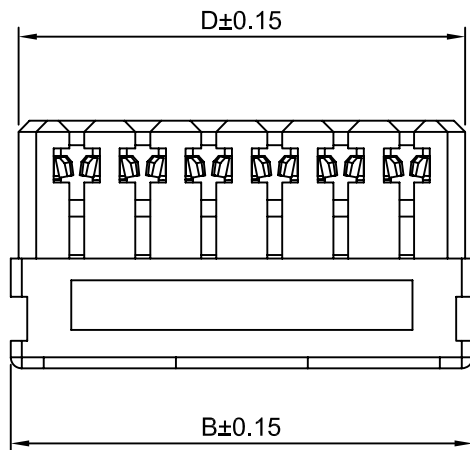

Circuits	Dimensions(mm)				Circuits	Dimensions(mm)			
	A	B	C	D		A	B	C	D
2P	0.60	1.80	1.35	1.65	12P	6.60	7.80	7.35	7.65
3P	1.20	2.40	1.95	2.25	13P	7.20	8.40	7.95	8.25
4P	1.80	3.00	2.55	2.85	14P	7.80	9.00	8.55	8.85
5P	2.40	3.60	3.15	3.45	15P	8.40	9.60	9.15	9.45
6P	3.00	4.20	3.75	4.05	16P	9.00	10.20	9.75	10.05
7P	3.60	4.80	4.35	4.65	17P	9.60	10.80	10.35	10.65
8P	4.20	5.40	4.95	5.25	18P	10.20	11.40	10.95	11.25
9P	4.80	6.00	5.55	5.85	19P	10.80	12.00	11.55	11.85
10P	5.40	6.60	6.15	6.45	20P	11.40	12.60	12.15	12.45
11P	6.00	7.20	6.75	7.05					

**CJTconn** CHANGJIANG CONNECTORS CO.,LTD.

Unit	Scale	Sheet
mm	15:1	1 of 1

Title :  
**0.60mm PITCH**  
**Housing**

Draw BY:	Approved :
Tony Su	Jack Yin

General Tolerance

x.x≤0.25	ANGLE±
x.xx≤0.20	
x.xxx≤0.15	

DRAW NO :	D0601H-XP	REV	A0
-----------	-----------	-----	----

A0	NEW RELEASE	2005.07.01
REV	DESCRIPTION	DATE