

Ordering Information:

A2361F-GCA - \*\*\*  
1 2

1.Part NO.

2.Finish:

(Blank): Gold over Nickel (Au:1u")

G15: Gold over Nickel (Au:15u"Mating area)

G30: Gold over Nickel (Au:30u"Mating area)

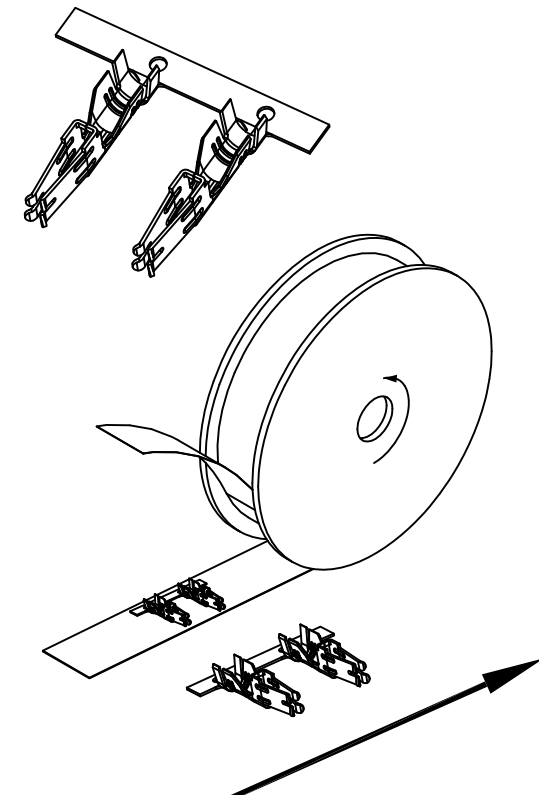
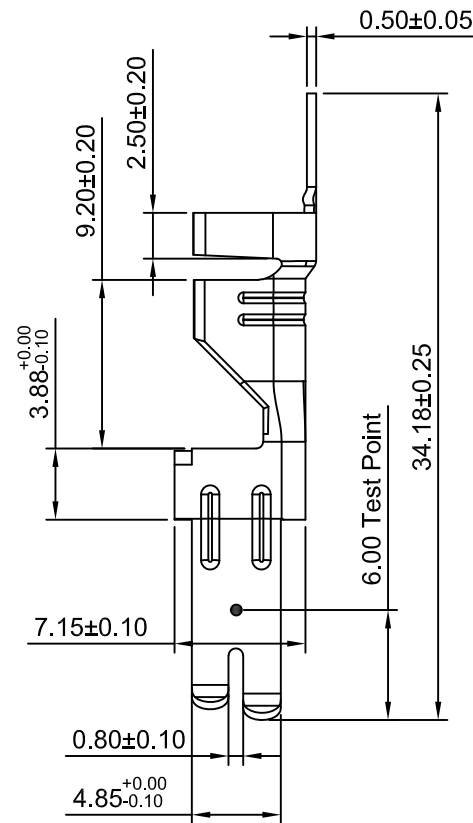
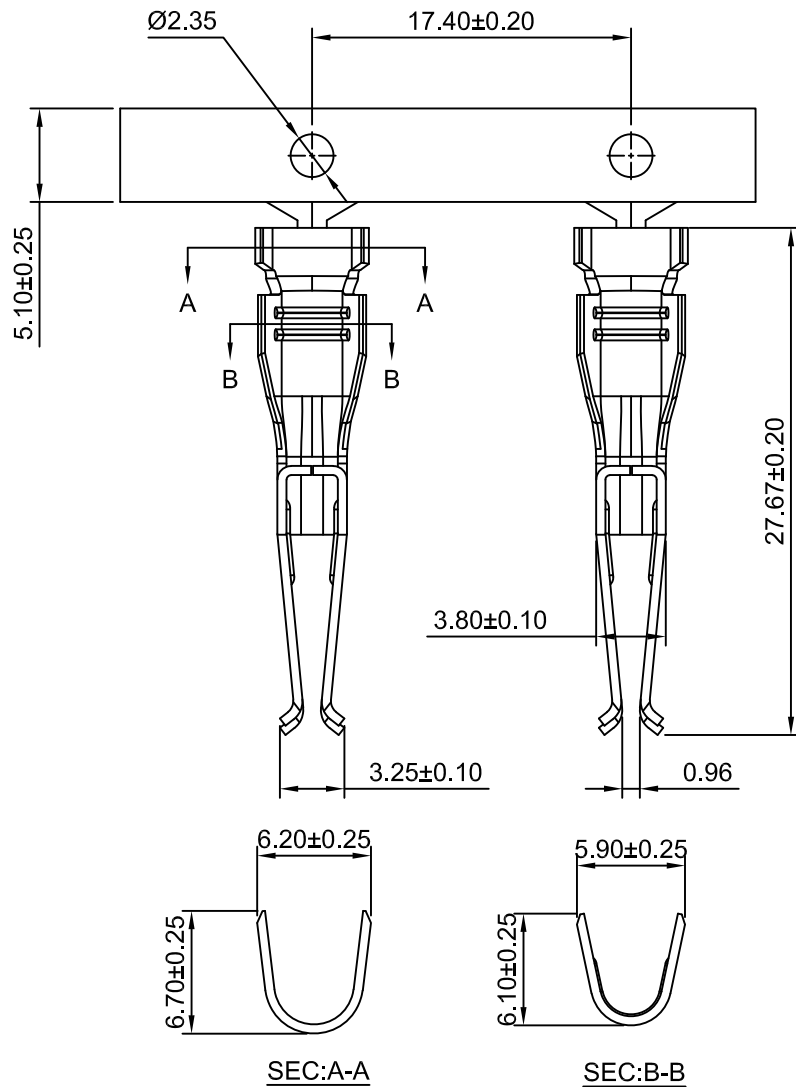

Ordering information & Specifications

Unit:mm

Part NO.	Wire Range	Insultion O.D.	Material	Finish	Qty/reel
A2361F-TCA	AWG#10-#12	5.30mm(max)	High conductive copper alloy	Tin over Nickel	2,500 PCS
A2361F-GCA	AWG#10-#12	5.30mm(max)	High conductive copper alloy	Gold over Nickel	2,500 PCS

REV	DESCRIPTION	DATE
A0	NEW RELEASE	2022.04.09

**CJTconn** CHANGJIANG CONNECTORS CO.,LTD.

Unit	Scale	Sheet	TITLE
mm	2.5:1	1 of 1	10.00mm PITCH CRIMP FLEX TERMINAL
DRWN	CHK'D	APPR	
Wenmin Luo	Diankui Wan	Jack Yin	DRAWING NO.
General Tolerances			THIRD ANGLE PROJECTION
x.xx±0.25 x.xxx±0.20 x.xxxx±0.15 ANGLES ±1°			A2361F-T
			REV A0